



**Make Your  
Visual Installations  
Easier and Faster with**  
**ut urbantrapeze™**

# Crimpleless Installation with UrbanTrapeze™

Our UrbanTrapeze cable gripper works with steel cable to create an adjustable, connecting loop. Make ceiling display installations quick and easy while eliminating the need for crimps or traditional aircraft cable fittings. Each UrbanTrapeze requires 7x7 uncoated, galvanized steel cable which is also available through Ceiling Outfitters®.

## Choose an UrbanTrapeze™

- Easy to use, self locking cable adjuster
- Eliminate crimps and ferrules from the installation process
- No need for swaging tools used with crimps
- Incrementally change the height or level the display with either clutch button
- Sleek, modern anodized aluminum finish
- Available in two models
  - UT 1.5 uses 1/16" cable
  - UT 3.0 uses 1/8" cable



**UrbanTrapeze 1.5**  
**Item No. 63-10015**  
(80-lb static holding power)  
(48-lb dynamic holding power)  
(480-lb cable break strength)  
(Uses 1/16-inch 7x7 uncoated steel cable)  
(Not recommended for outdoor use)



**UrbanTrapeze 3.0**  
**Item No. 63-10030**  
(300-lb static holding power)  
(170-lb dynamic holding power)  
(1,417-lb cable break strength)  
(Uses 1/8-inch 7x7 uncoated steel cable)  
(Not recommended for outdoor use)

## Create a Loop

Feed the free end of your cable through either UrbanTrapeze clutch button into the self-locking brake which grips the cable automatically. **1**

Guide the cable through the display connection point and into the other clutch button, completing the installation with a secure and stable loop. **2**

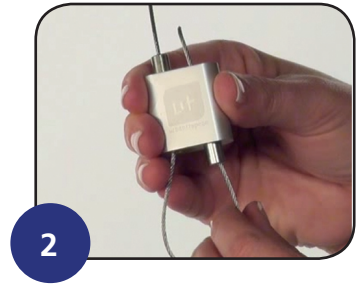
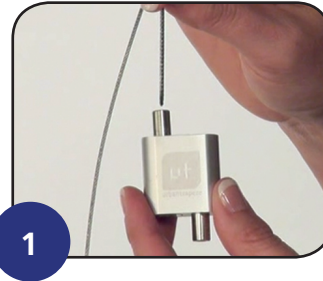

## Adjust the Loop

Press and hold either clutch button to release the braking system, allowing for quick and easy adjustments – no more starting over by cutting new cable. **3** **4**

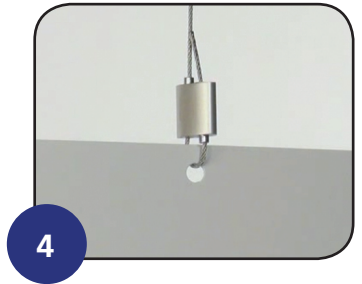
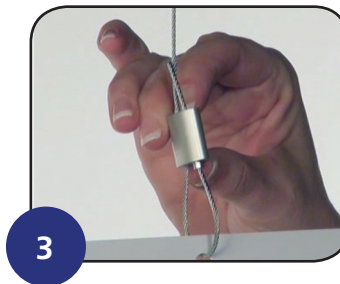

Contact us for a complementary sample to test in your environment.  
Visit our website to place your order and for simple instructional videos and downloads.

# Adjustable Loop Promotes Efficient and Safe Installations for Ceiling Displays

## Simple Solution for:

- Aisle Markers
- Signs
- Ceiling Grids
- Lighting Systems

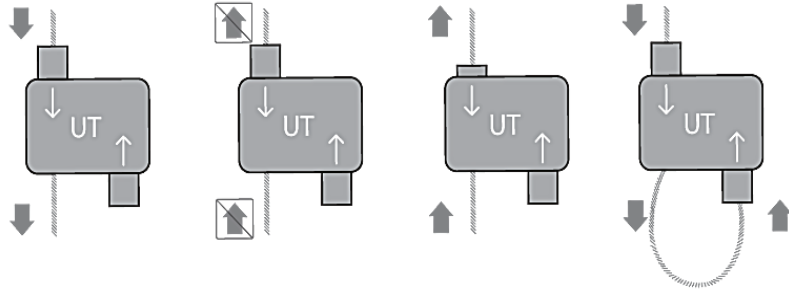

Item	Static Holding Power (Approximate)	Dynamic Holding Power (Approximate)	Cable Break Strength (Approximate)	Cable Type
UrbanTrapeze 1.5	80 lbs each UT	48 lbs each UT	470 lbs	1/16" uncoated 7x7
UrbanTrapeze 3.0	300 lbs each UT	170 lbs each UT	1,417 lbs	1/8" uncoated 7x7

For maximum holding power, use only 7x7 uncoated steel cable.  
 \*Available in anodized aluminum; black available as custom order.  
 1/16" and 1/8" steel cable available in 100, 250, and 500-foot spools.